



## **InGranite Recon Ltd.**

Cast Stone | Modern Material | Classic Style

# Door & Window Surrounds

### Contact

Phone:

Email:

Web:

### UK

0808 2349 118

[info@ingranite.co.uk](mailto:info@ingranite.co.uk)

[www.ingranite.co.uk](http://www.ingranite.co.uk)

### Rep. Irl.

057 9331 462

[info@ingranite.ie](mailto:info@ingranite.ie)

[www.ingranite.ie](http://www.ingranite.ie)







## **InGranite Recon Ltd.**

Cast Stone | Modern Material | Classic Style

# Door & Window Surrounds

InGranite Recon manufactures a range of cast stone door surrounds units in beautiful and durable reconstituted granite and for design consistency on your project we also manufacture a matching range of window surrounds units.

Please contact us if you require a bespoke or modified design for your project.

#### Contact

Phone:

Email:

Web:

#### UK

0808 2349 118

[info@ingranite.co.uk](mailto:info@ingranite.co.uk)

[www.ingranite.co.uk](http://www.ingranite.co.uk)

#### Rep. Irl.

057 9331 462

[info@ingranite.ie](mailto:info@ingranite.ie)

[www.ingranite.ie](http://www.ingranite.ie)



# InGranite Recon Ltd.

Reconstituted Stone | Modern Material | Classic Style

UK info@ingranite.co.uk

www.ingranite.co.uk

0808 2349118

RoI info@ingranite.ie

www.ingranite.ie

057 9331462

## Technical specification sheet

Title: Door surround A

Date: 12/03/2017

Ref: FDS 3250

Scale: 1:40

Drawn by: InGranite

Approximate weight:

64.5kgs/meter

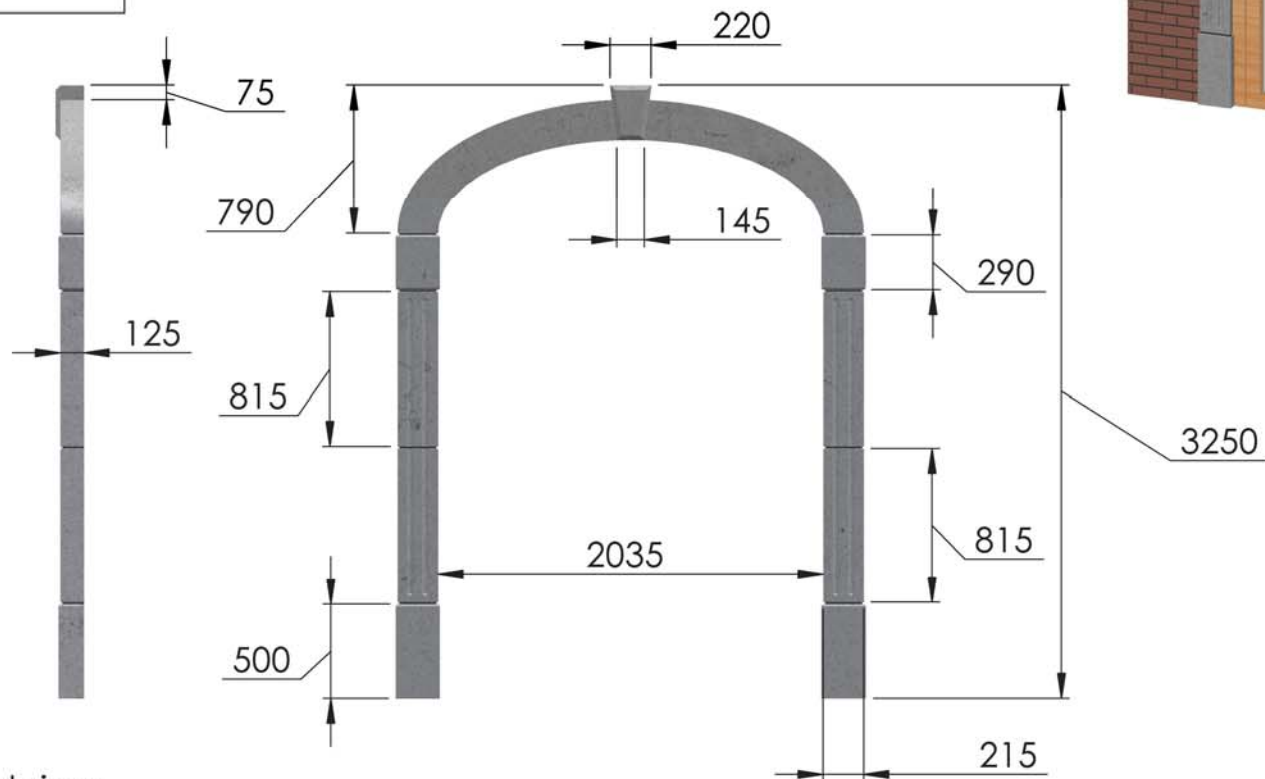

All dimensions are in millimetres. For non listed sizes please contact InGranite Recon LTD.

All vertical faces typically have a 4mm taper per 100mm of height.

The information contained in this drawing was correct at the time of going to print. Profiles, sizes and weights are given as indication only.



# InGranite Recon Ltd.

Reconstituted Stone | Modern Material | Classic Style

UK info@ingranite.co.uk

www.ingranite.co.uk

0808 2349118

RoI info@ingranite.ie

www.ingranite.ie

057 9331462

## Technical specification sheet

Title: Door surround B

Date: 12/03/2017

Ref: SFD 3100

Scale: 1:40

Drawn by: InGranite

Approximate weight:

64.5kgs/meter

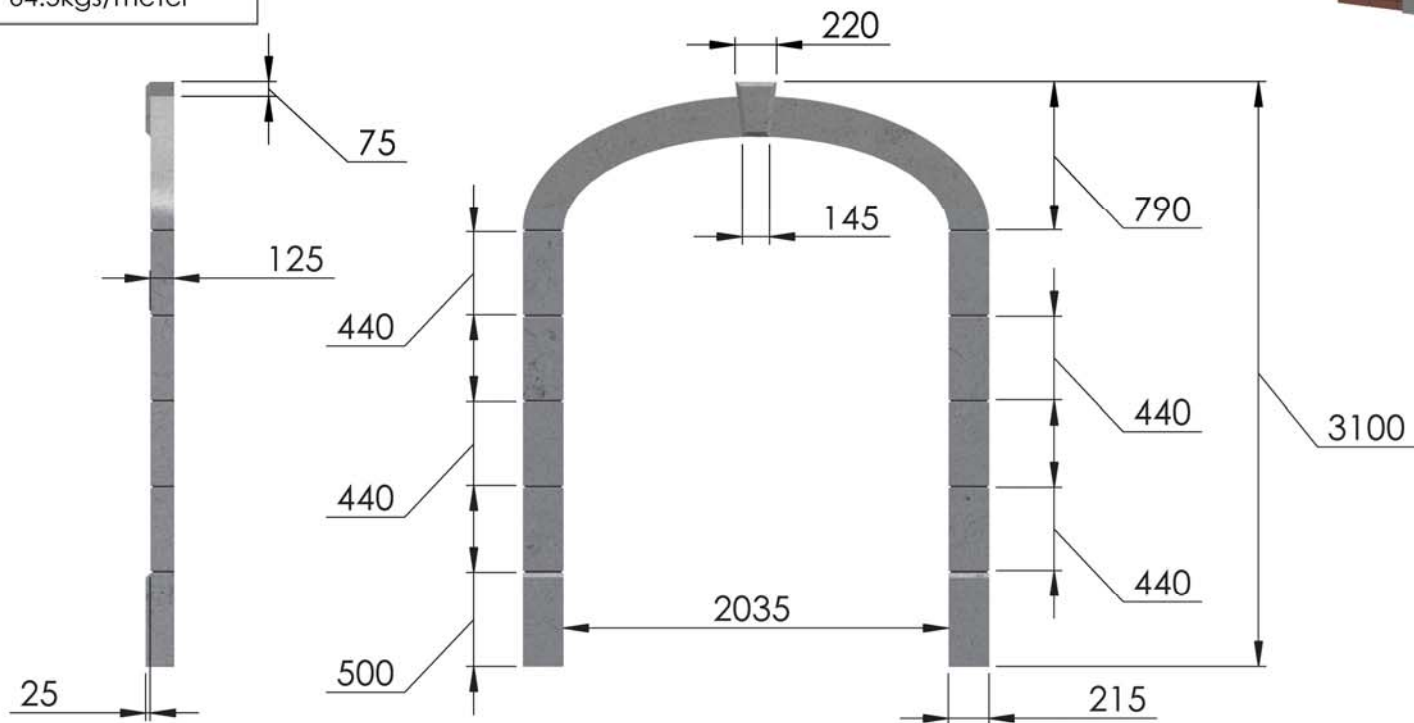

All dimensions are in millimetres. For non listed sizes please contact InGranite Recon LTD.

All vertical faces typically have a 4mm taper per 100mm of height.

The information contained in this drawing was correct at the time of going to print. Profiles, sizes and weights are given as indication only.



# InGranite Recon Ltd.

Reconstituted Stone | Modern Material | Classic Style

UK info@ingranite.co.uk

www.ingranite.co.uk

0808 2349118

RoI info@ingranite.ie

www.ingranite.ie

057 9331462

## Technical specification sheet

Title: Door surround C

Date: 19/03/2017

Ref: CAH 2500/1200

Scale: 1:40

Drawn by: InGranite

Approximate weight:

64.5kgs/meter

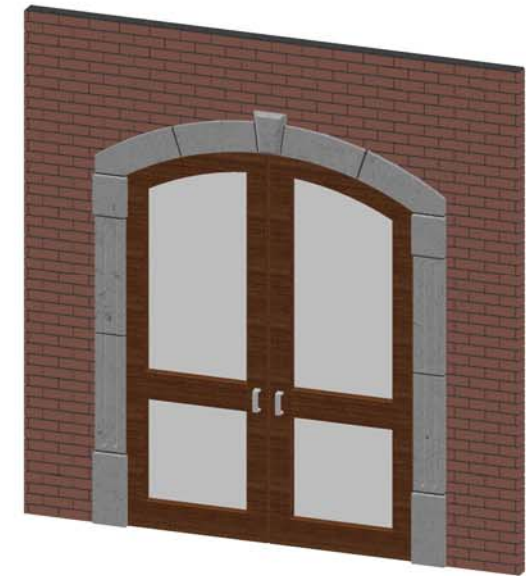
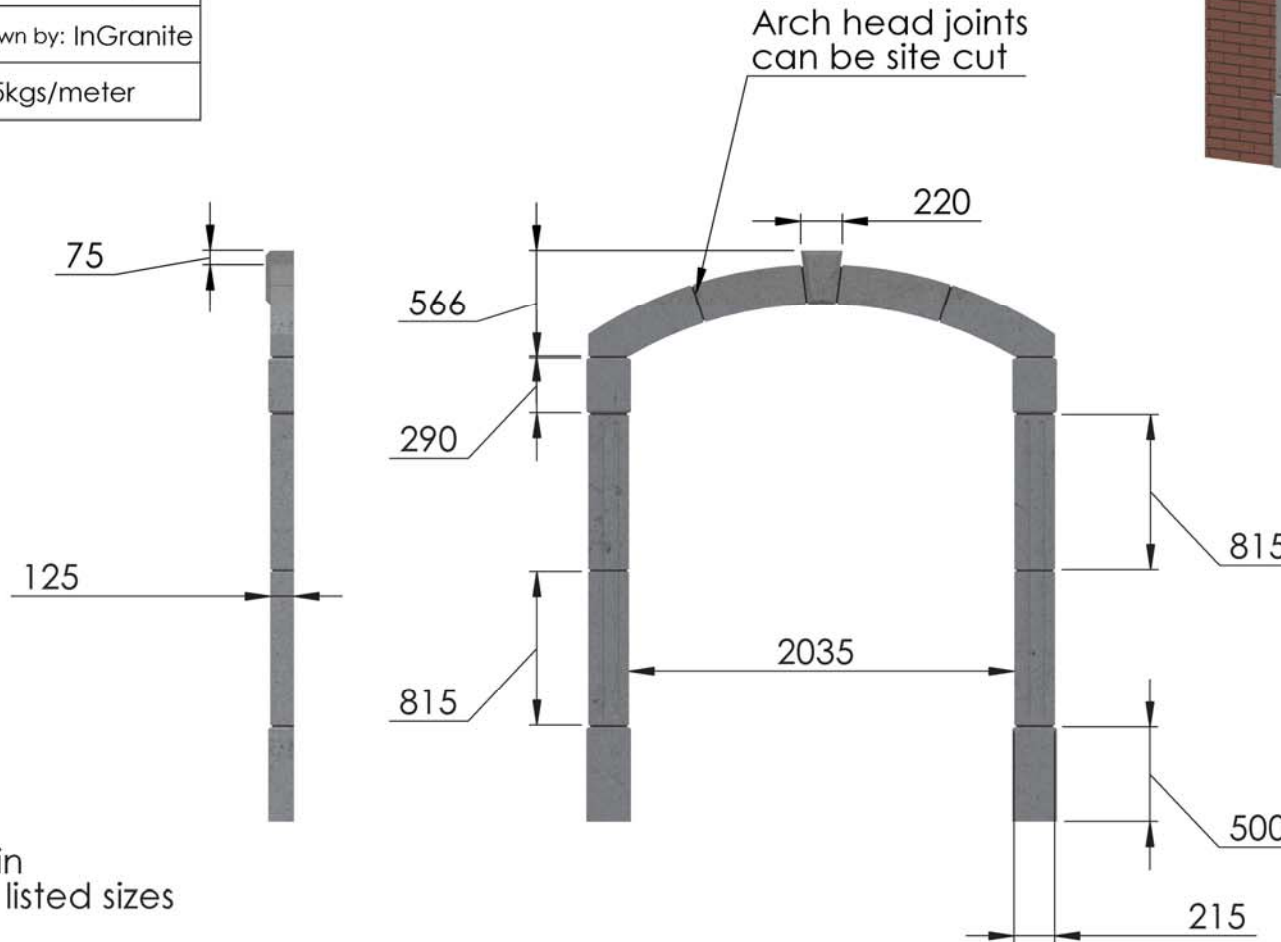

All dimensions are in millimetres. For non listed sizes please contact InGranite Recon LTD.

All vertical faces typically have a 4mm taper per 100mm of height.

The information contained in this drawing was correct at the time of going to print. Profiles, sizes and weights are given as indication only.



# InGranite Recon Ltd.

Reconstituted Stone | Modern Material | Classic Style

UK info@ingranite.co.uk

RoI info@ingranite.ie

www.ingranite.co.uk

www.ingranite.ie

0808 2349118

057 9331462

## Technical specification sheet

Title: Door surround D

Date: 19/03/2017

Ref: DAH 2500/1200

Scale: 1:40

Drawn by: InGranite

Approximate weight:

64.5kgs/meter

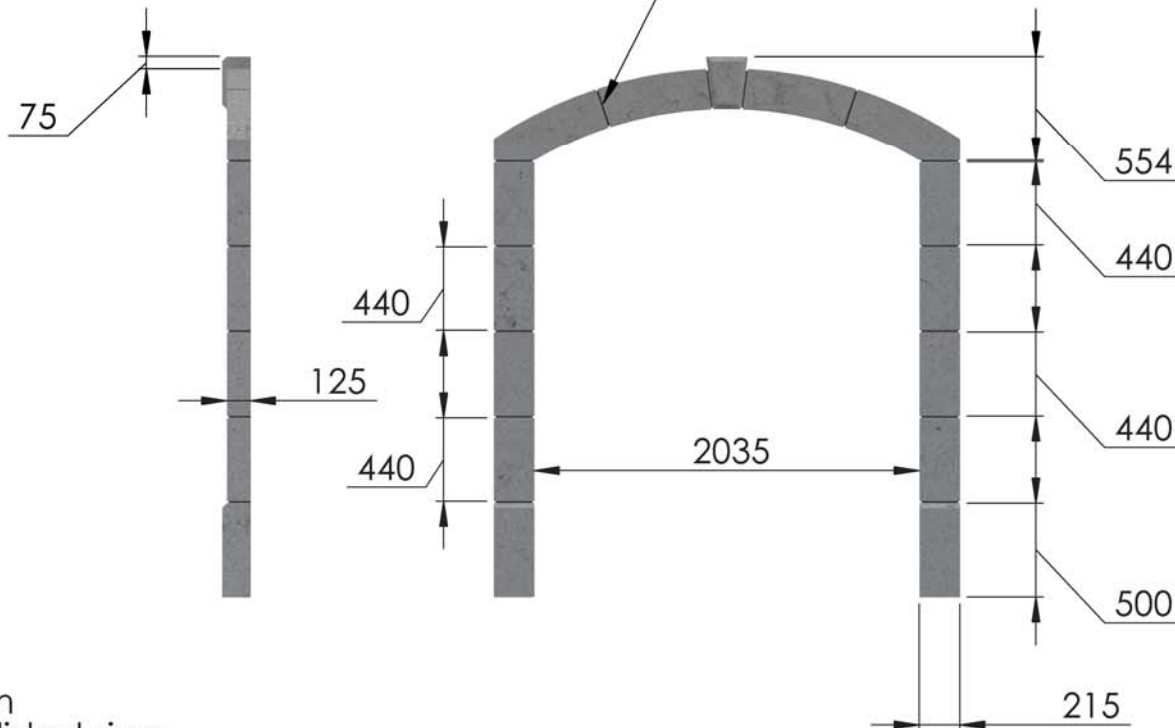

All dimensions are in millimetres. For non listed sizes please contact InGranite Recon LTD.

All vertical faces typically have a 4mm taper per 100mm of height.

The information contained in this drawing was correct at the time of going to print. Profiles, sizes and weights are given as indication only.



# InGranite Recon Ltd.

Reconstituted Stone | Modern Material | Classic Style

UK info@ingranite.co.uk

www.ingranite.co.uk

0808 2349118

RoI info@ingranite.ie

www.ingranite.ie

057 9331462

## Technical specification sheet

Title: Door surround E

Date: 24/03/2017

Ref: FDS 2615

Scale: 1:40

Drawn by: InGranite

Approximate weight:

64.5kgs/meter

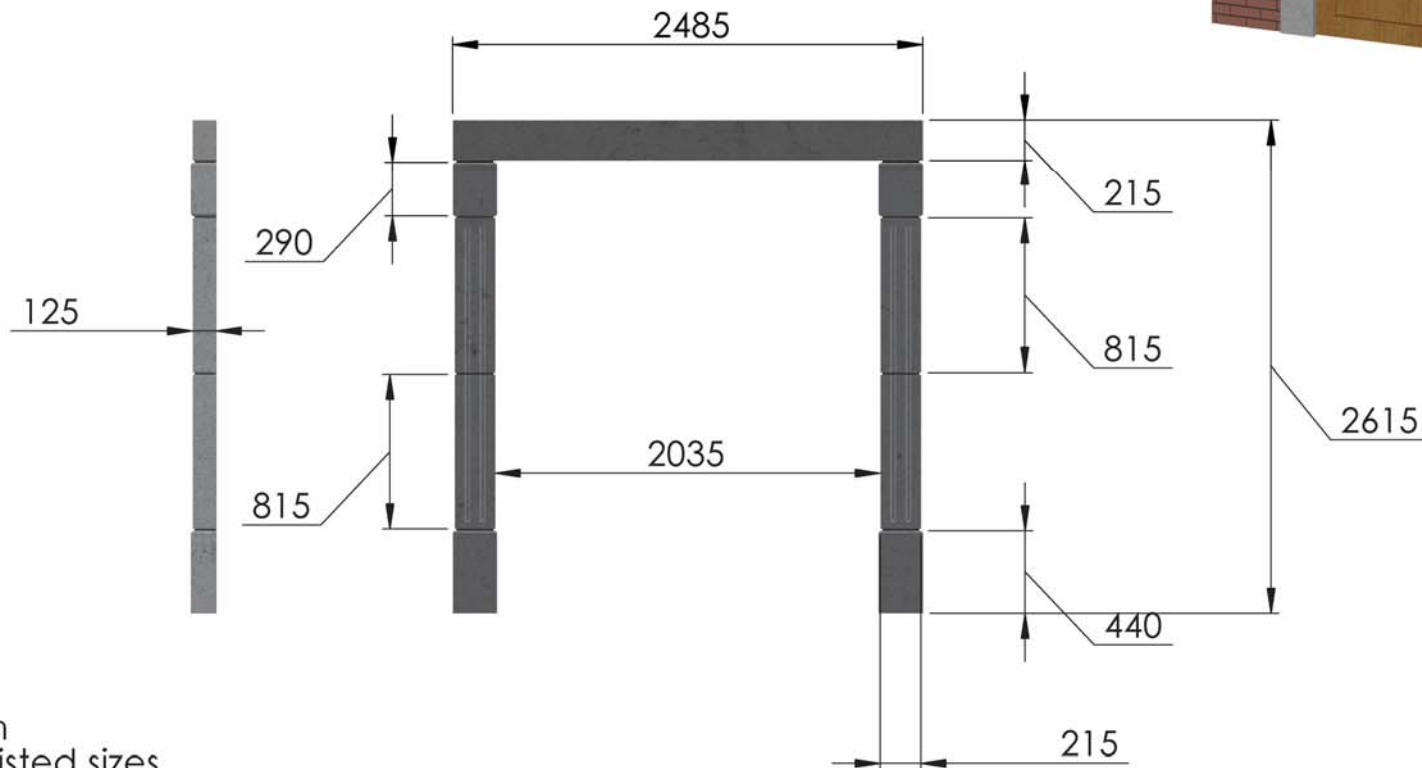

All dimensions are in millimetres. For non listed sizes please contact InGranite Recon LTD.

All vertical faces typically have a 4mm taper per 100mm of height.

The information contained in this drawing was correct at the time of going to print. Profiles, sizes and weights are given as indication only.





# InGranite Recon Ltd.

Reconstituted Stone | Modern Material | Classic Style

UK info@ingranite.co.uk

www.ingranite.co.uk

0808 2349118

RoI info@ingranite.ie

www.ingranite.ie

057 9331462

## Technical specification sheet

Title: Door surround F

Date: 24/03/2017

Ref: FDS 2700

Scale: 1:40

Drawn by: InGranite

Approximate weight:

64.5kgs/meter

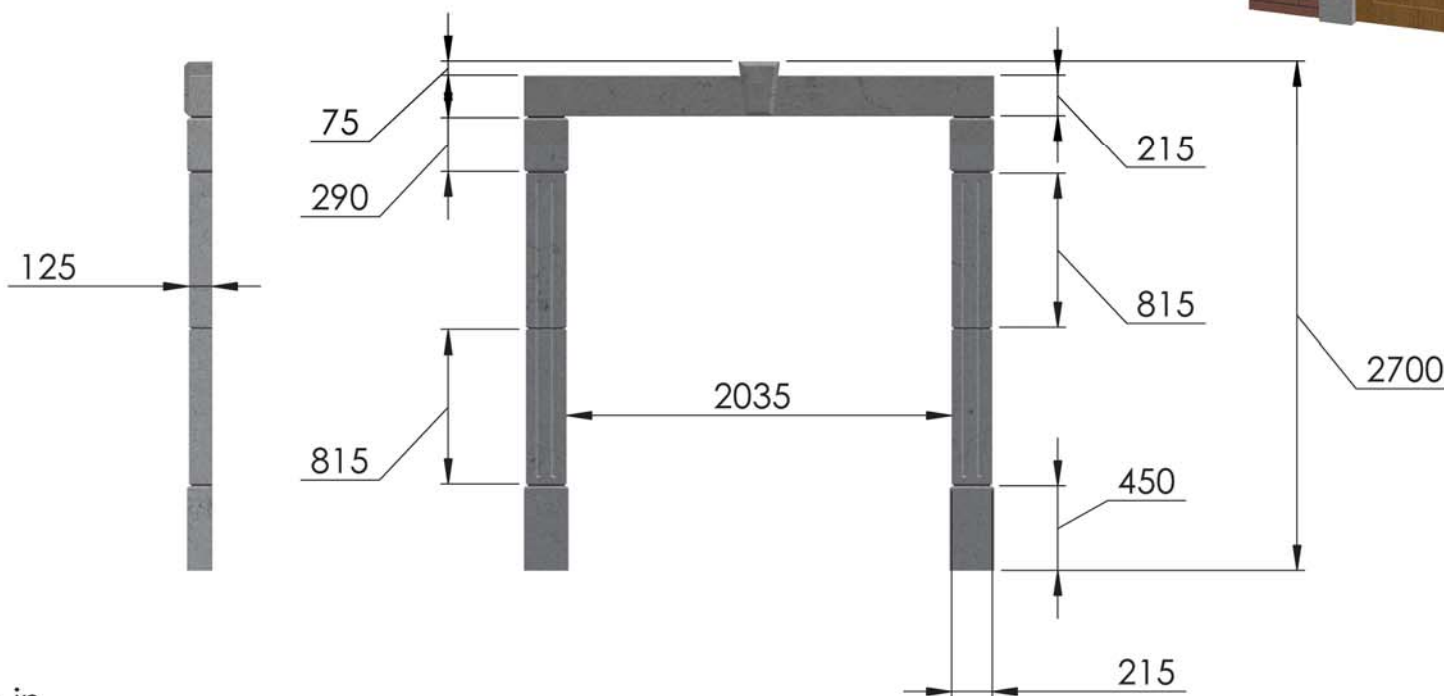

All dimensions are in millimetres. For non listed sizes please contact InGranite Recon LTD.

All vertical faces typically have a 4mm taper per 100mm of height.

The information contained in this drawing was correct at the time of going to print. Profiles, sizes and weights are given as indication only.



# InGranite Recon Ltd.

Reconstituted Stone | Modern Material | Classic Style

UK info@ingranite.co.uk

www.ingranite.co.uk

0808 2349118

RoI info@ingranite.ie

www.ingranite.ie

057 9331462

## Technical specification sheet

Title: Door surround G

Date: 24/03/2017

Ref: SFD 2465

Scale: 1:40

Drawn by: InGranite

Approximate weight: 64.5kgs/meter

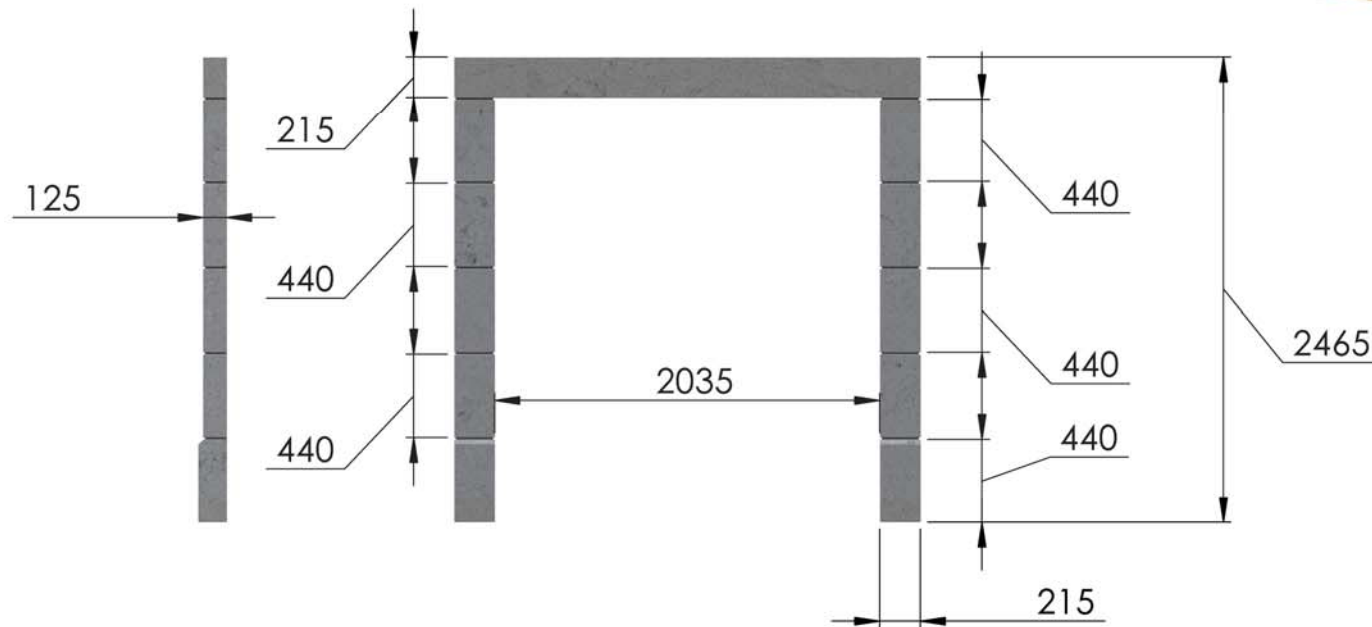

All dimensions are in millimetres. For non listed sizes please contact InGranite Recon LTD.

All vertical faces typically have a 4mm taper per 100mm of height.

The information contained in this drawing was correct at the time of going to print. Profiles, sizes and weights are given as indication only.



# InGranite Recon Ltd.

Reconstituted Stone | Modern Material | Classic Style

UK info@ingranite.co.uk

www.ingranite.co.uk

0808 2349118

RoI info@ingranite.ie

www.ingranite.ie

057 9331462

## Technical specification sheet

Title: Door surround H

Date: 24/03/2017

Ref: SFD 2540

Scale: 1:40

Drawn by: InGranite

Approximate weight: 64.5kgs/meter

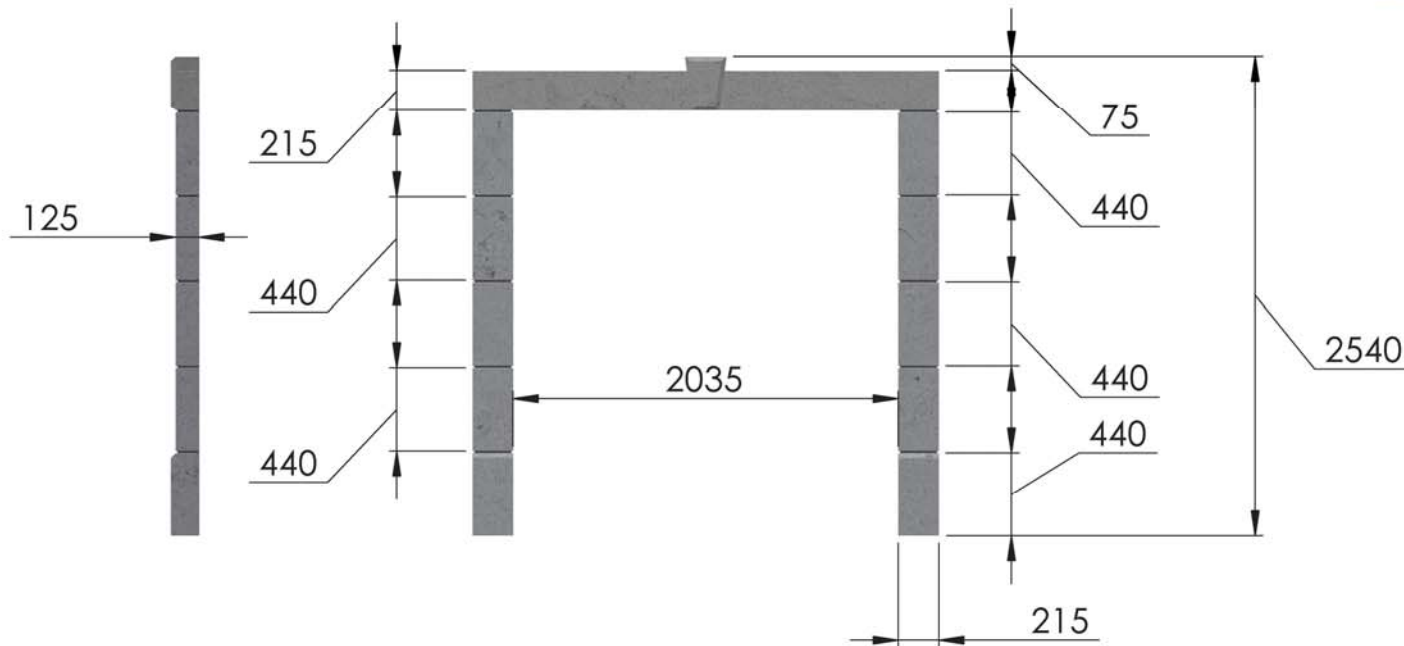

All dimensions are in millimetres. For non listed sizes please contact InGranite Recon LTD.

All vertical faces typically have a 4mm taper per 100mm of height.

The information contained in this drawing was correct at the time of going to print. Profiles, sizes and weights are given as indication only.



**InGranite Recon Ltd.**

Reconstituted Stone | Modern Material | Classic Style

UK info@ingranite.co.uk

RoI info@ingranite.ie

www.ingranite.co.uk

www.ingranite.ie

0808 2349118

057 9331462

### Technical specification sheet

Title: Door surround I

Date: 18/04/2017

Ref: Ashbourne I

Scale: 1:25

Drawn by: InGranite

Approximate weight: 33.5kgs/meter

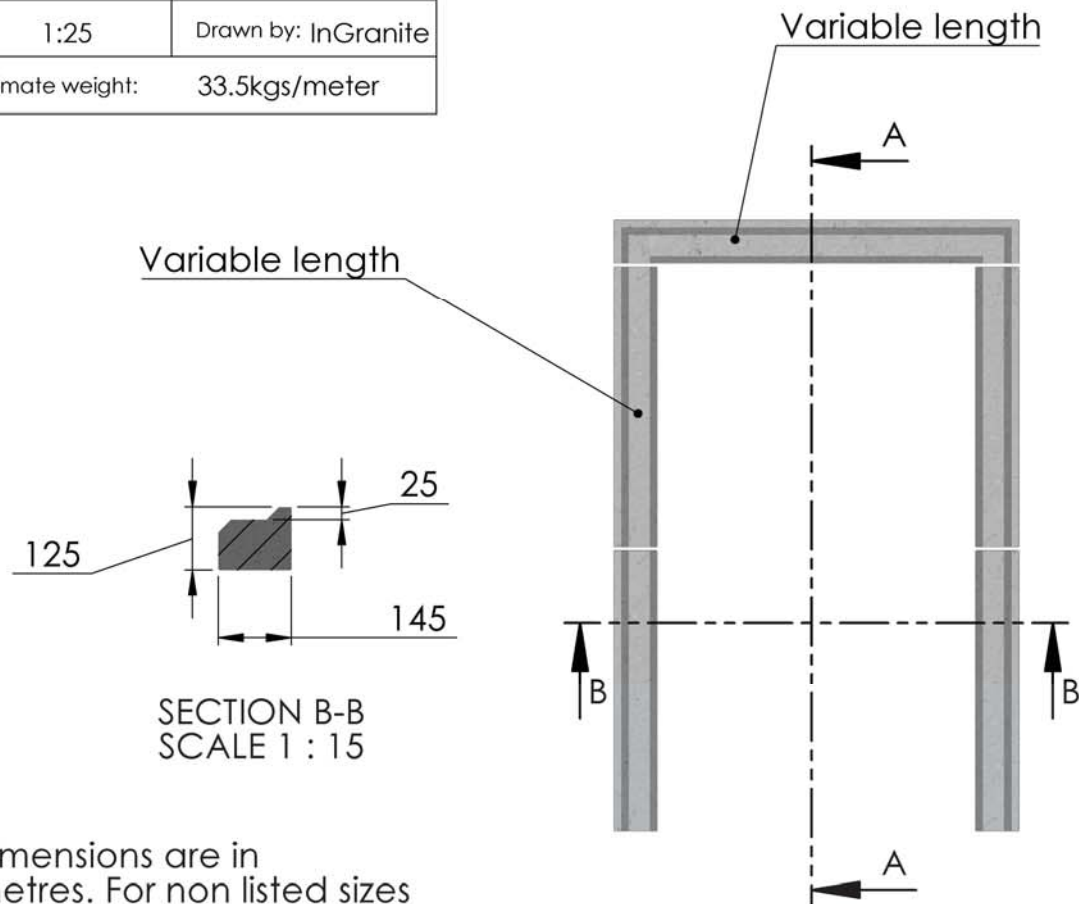

Variable length

Variable length

SECTION B-B  
SCALE 1 : 15

SECTION A-A  
SCALE 1 : 15

All dimensions are in millimetres. For non listed sizes please contact InGranite Recon LTD.

All vertical faces typically have a 4mm taper per 100mm of height.

The information contained in this drawing was correct at the time of going to print. Profiles, sizes and weights are given as indication only.





# InGranite Recon Ltd.

Reconstituted Stone | Modern Material | Classic Style

UK info@ingranite.co.uk

RoI info@ingranite.ie

www.ingranite.co.uk

www.ingranite.ie

0808 2349118

057 9331462

## Technical specification sheet

Title: Door surround J

Date: 18/04/2017

Ref: Rathgar J

Scale: 1:25

Drawn by: InGranite

Approximate weight:

38kgs/meter

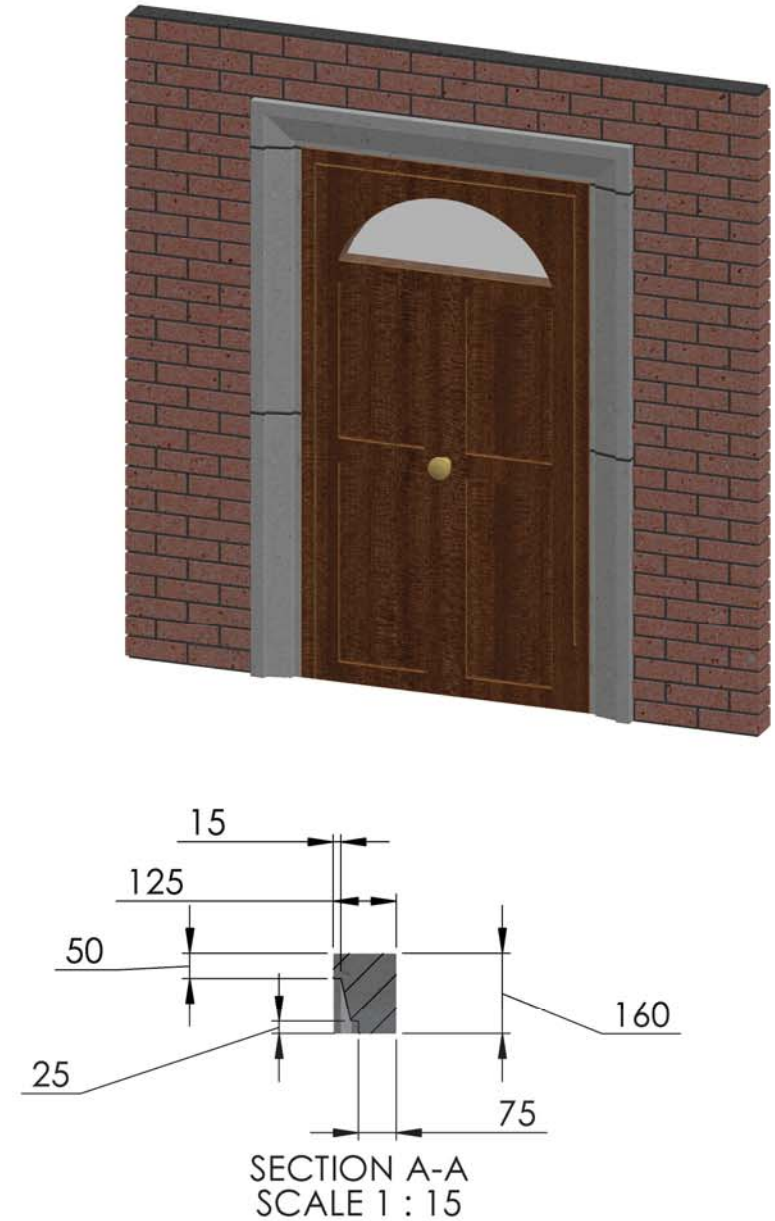
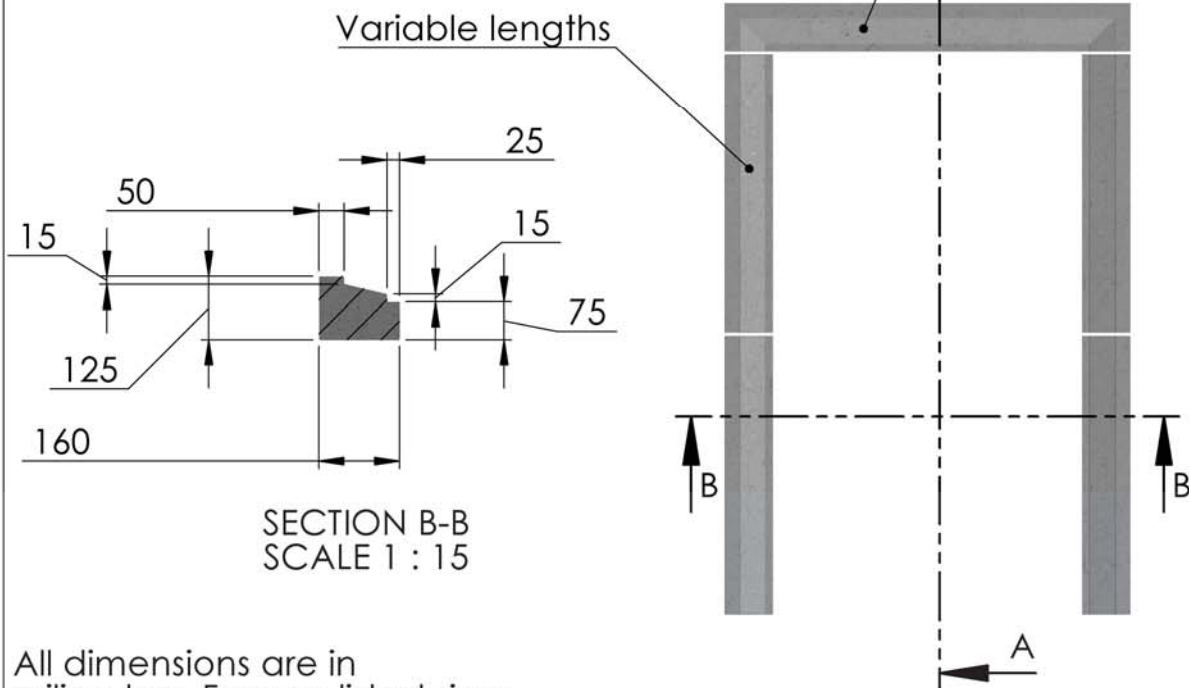

All dimensions are in millimetres. For non listed sizes please contact InGranite Recon LTD.

All vertical faces typically have a 4mm taper per 100mm of height.

The information contained in this drawing was correct at the time of going to print. Profiles, sizes and weights are given as indication only.



# InGranite Recon Ltd.

Reconstituted Stone | Modern Material | Classic Style

UK info@ingranite.co.uk

www.ingranite.co.uk

0808 2349118

RoI info@ingranite.ie

www.ingranite.ie

057 9331462

## Technical specification sheet

Title: Stone arch heads

Date: 12/03/2017

Ref: AH 1200/2500

Scale: 1:15

Drawn by: InGranite

Approximate weight:

64.5kgs/meter

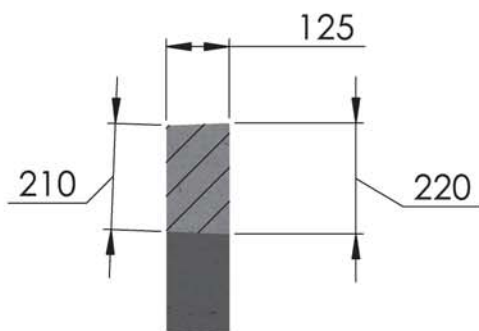

SECTION A-A  
SCALE 1 : 15

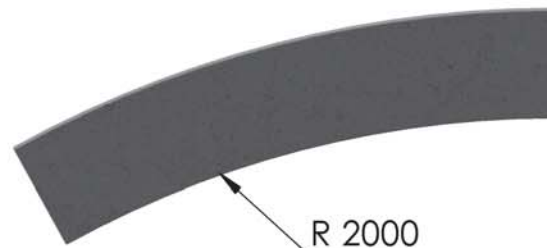

R 2000

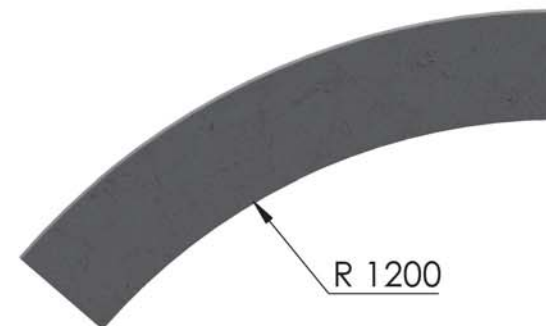

R 1200

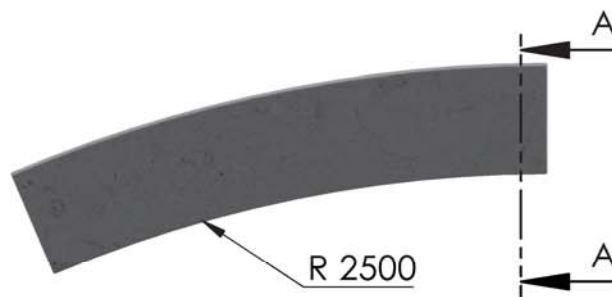

R 2500

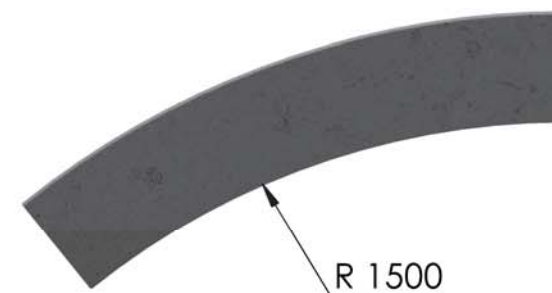

R 1500

All dimensions are in millimetres. For non listed sizes please contact InGranite Recon LTD.

All vertical faces typically have a 4mm taper per 100mm of height.

The information contained in this drawing was correct at the time of going to print. Profiles, sizes and weights are given as indication only.



# InGranite Recon Ltd.

Reconstituted Stone | Modern Material | Classic Style

UK info@ingranite.co.uk

www.ingranite.co.uk

0808 2349118

RoI info@ingranite.ie

www.ingranite.ie

057 9331462

## Technical specification sheet

Title: Porthole window surrounds

Date: 11/04/2017

Ref: PW 900/920

Scale: 1:20

Drawn by: InGranite

Approximate weight:

PW 900 = 75kgs

PW 920 = 92kgs

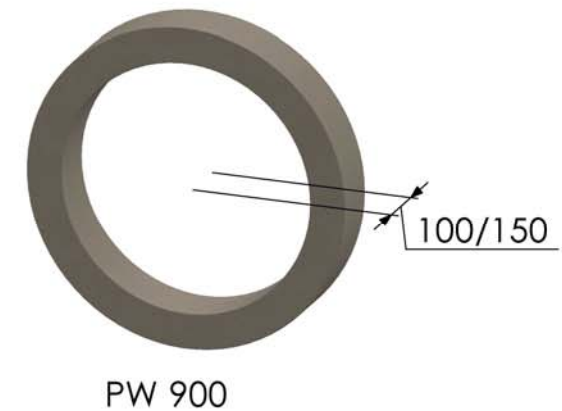
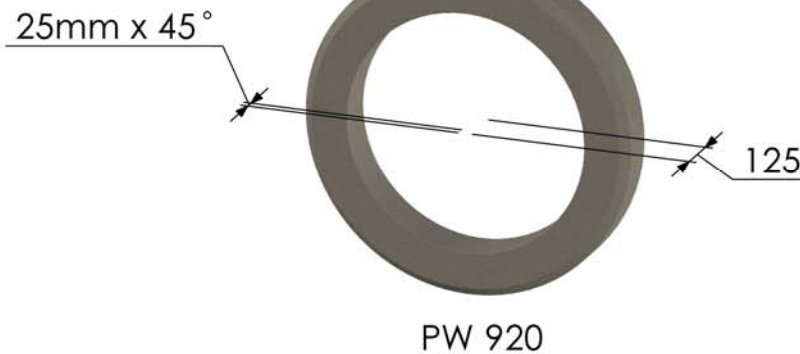
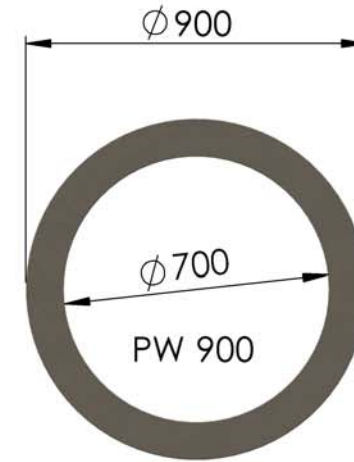
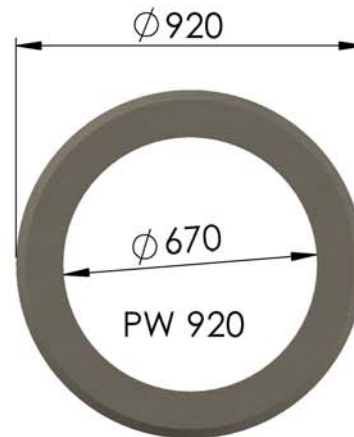

All dimensions are in millimetres. For non listed sizes please contact InGranite Recon LTD.

All vertical faces typically have a 4mm taper per 100mm of height.

The information contained in this drawing was correct at the time of going to print. Profiles, sizes and weights are given as indication only.



# InGranite Recon Ltd.

Reconstituted Stone | Modern Material | Classic Style

UK info@ingranite.co.uk

www.ingranite.co.uk

0808 2349118

RoI info@ingranite.ie

www.ingranite.ie

057 9331462

## Technical specification sheet

Title: Ashbourne window surround

Date: 21/02/2017

Ref: Ashbourne

Scale: 1:10

Drawn by: InGranite

Approximate weight: 33.5kgs/meter

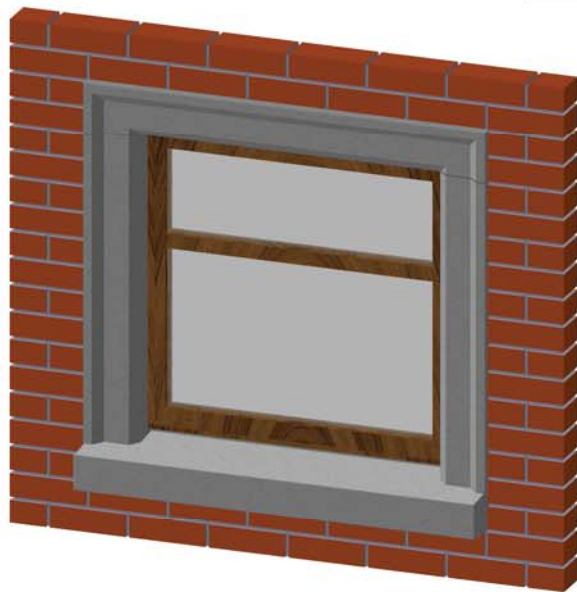

Variable length

Variable length

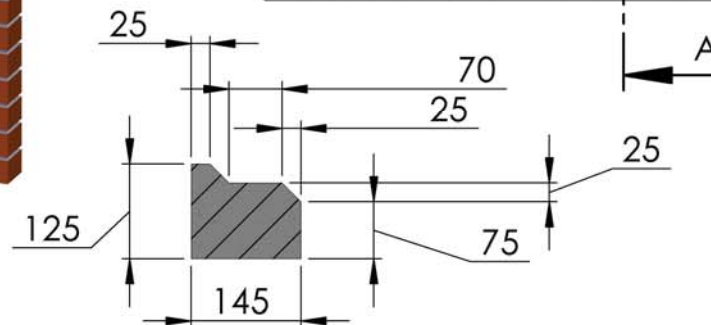

SECTION B-B  
SCALE 1 : 10

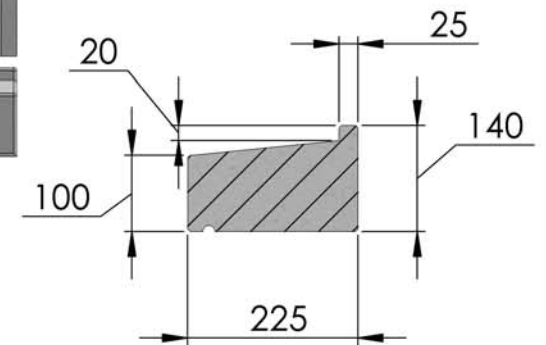
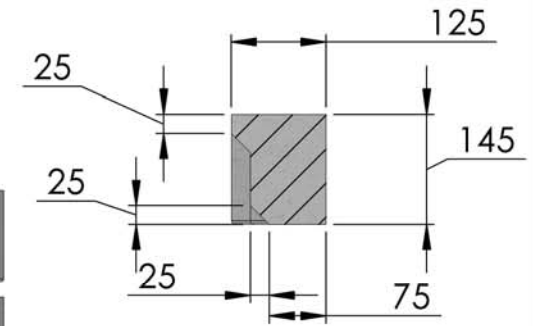

SECTION A-A  
SCALE 1 : 10

All dimensions are in millimetres. For non listed sizes please contact InGranite Recon LTD.

All vertical faces typically have a 4mm taper per 100mm of height.

The information contained in this drawing was correct at the time of going to print. Profiles, sizes and weights are given as indication only.





# InGranite Recon Ltd.

Reconstituted Stone | Modern Material | Classic Style

UK info@ingranite.co.uk

www.ingranite.co.uk

0808 2349118

RoI info@ingranite.ie

www.ingranite.ie

057 9331462

## Technical specification sheet

Title: Keystone surround

Date: 23/02/2017

Ref: Keystone

Scale: 1:20

Drawn by: InGranite

Approximate weight:

A=51.5kgs/meter

B=24kgs/meter

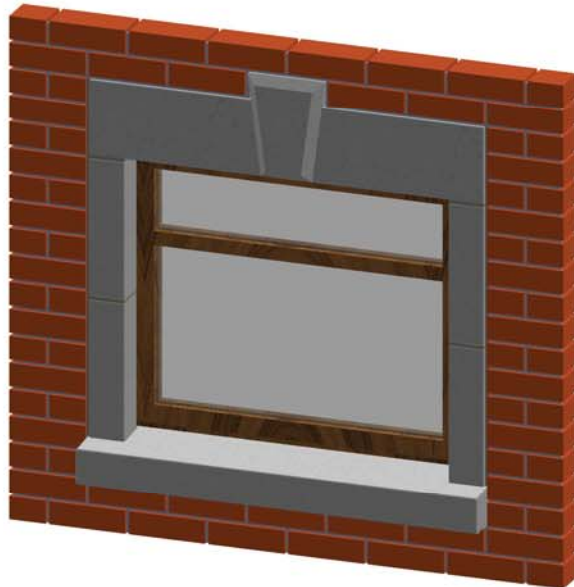

All dimensions are in millimetres. For non listed sizes please contact InGranite Recon LTD.

All vertical faces typically have a 4mm taper per 100mm of height.

The information contained in this drawing was correct at the time of going to print. Profiles, sizes and weights are given as indication only.

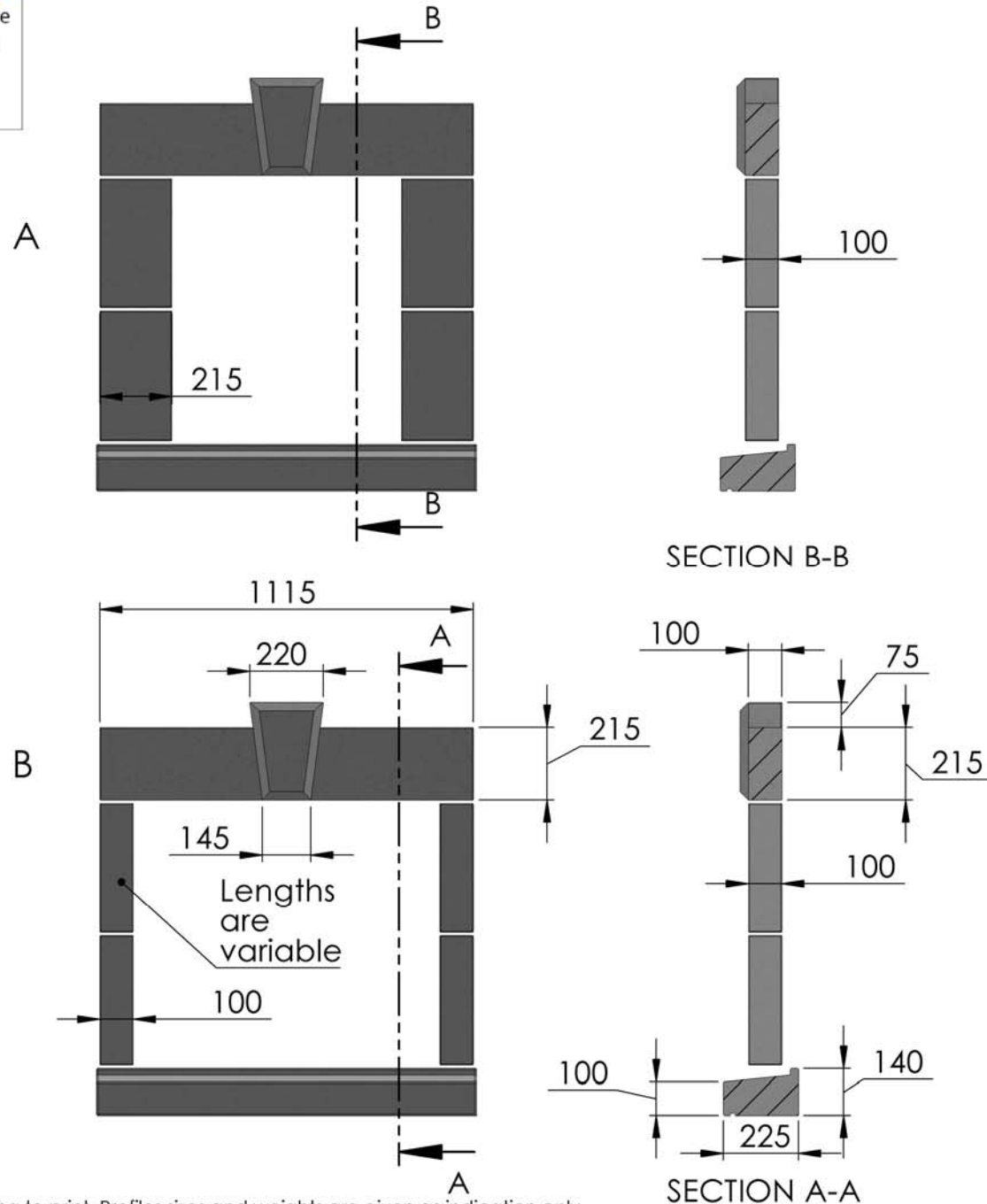

Head size
552
665
777
890
1002
1115
1227
1340
1452
1565
1677
1790
1902
2015
2127
2240
2352
2465
2578
2690



# InGranite Recon Ltd.

Reconstituted Stone | Modern Material | Classic Style

UK info@ingranite.co.uk

www.ingranite.co.uk

0808 2349118

RoI info@ingranite.ie

www.ingranite.ie

057 9331462

## Technical specification sheet

Title: Porthole window surround

Date: 07/04/2017

Ref: PW1250

Scale: 1:20

Drawn by: InGranite

Approximate weight:

37.5kgs/meter

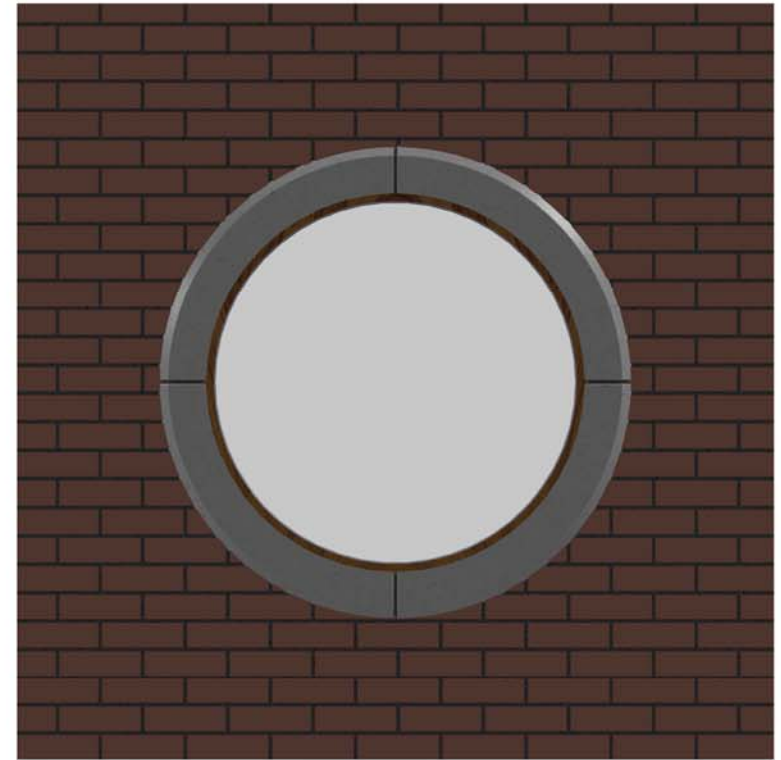
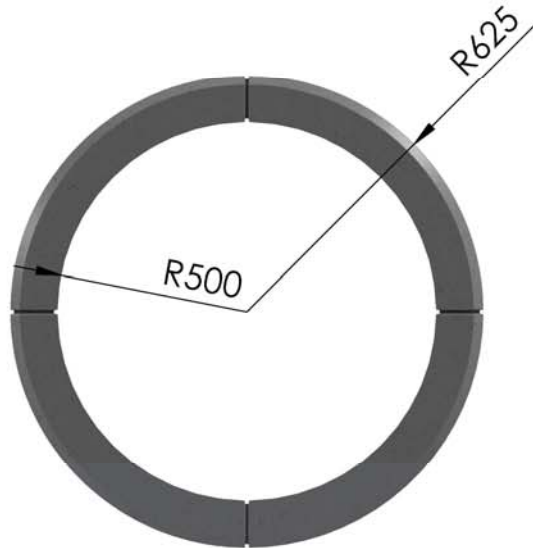

All dimensions are in millimetres. For non listed sizes please contact InGranite Recon LTD.

All vertical faces typically have a 4mm taper per 100mm of height.

The information contained in this drawing was correct at the time of going to print. Profiles, sizes and weights are given as indication only.



**InGranite Recon Ltd.**

Reconstituted Stone | Modern Material | Classic Style

UK info@ingranite.co.uk

RoI info@ingranite.ie

www.ingranite.co.uk

www.ingranite.ie

0808 2349118

057 9331462

### Technical specification sheet

Title: Rathgar window surround

Date: 21/02/2017

Ref: Rathgar

Scale: 1:10

Drawn by: InGranite

Approximate weight: 38kgs/meter

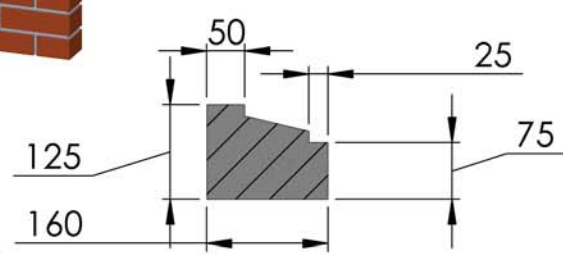
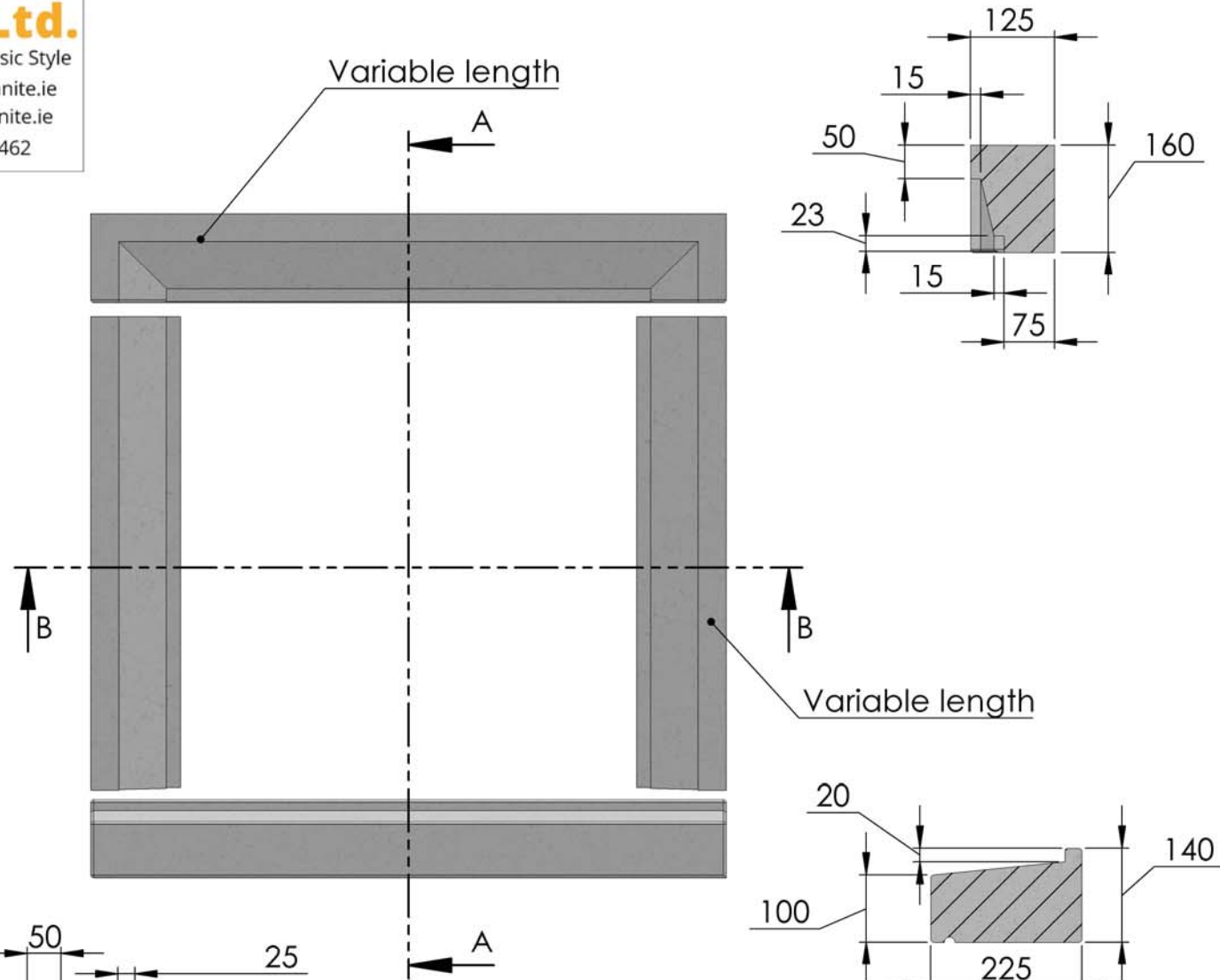
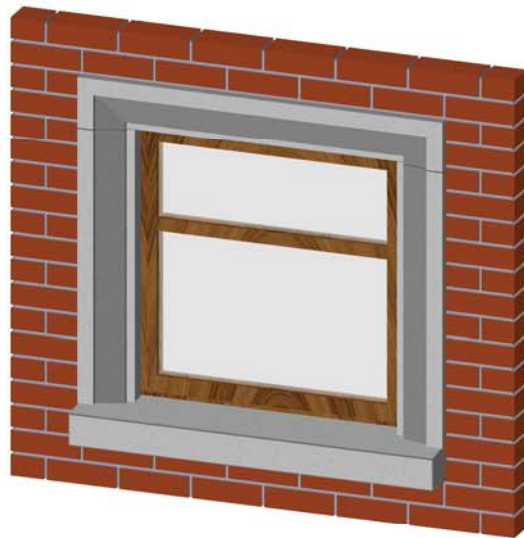

SECTION B-B  
SCALE 1 : 10

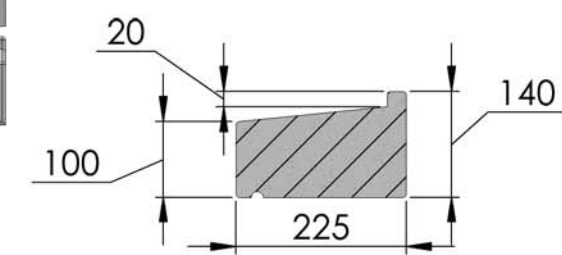

SECTION A-A  
SCALE 1 : 10

All dimensions are in millimetres. For non listed sizes please contact InGranite Recon LTD.

All vertical faces typically have a 4mm taper per 100mm of height.

The information contained in this drawing was correct at the time of going to print. Profiles, sizes and weights are given as indication only.



# InGranite Recon Ltd.

Reconstituted Stone | Modern Material | Classic Style

UK info@ingranite.co.uk

www.ingranite.co.uk

0808 2349118

RoI info@ingranite.ie

www.ingranite.ie

057 9331462

## Technical specification sheet

Title: Rock face head

Date: 28/02/2017

Ref: RH 552/2465

Scale: 1:10

Drawn by: InGranite

Approximate weight: 51.5kgs/meter

Head Size
552
665
777
890
1002
1115
1227
1340
1452
1565
1677
1790
1902
2015
2127
2240
2352
2465

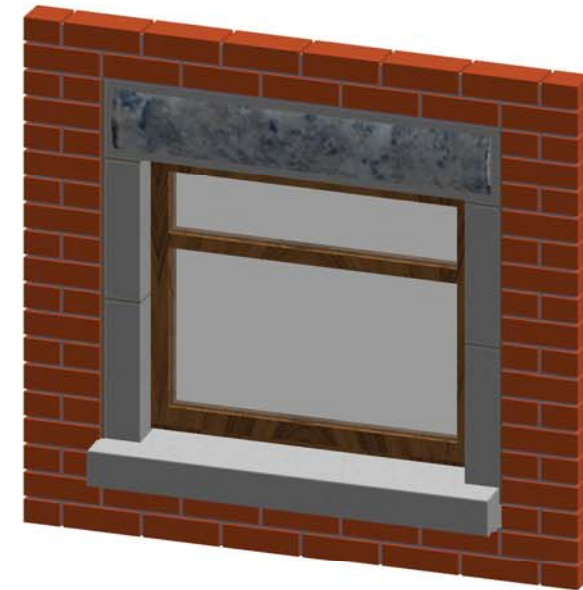
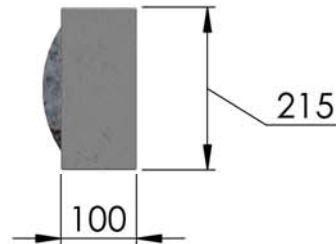

Rock face effect

All dimensions are in millimetres. For non listed sizes please contact InGranite Recon LTD.

All vertical faces typically have a 4mm taper per 100mm of height.

The information contained in this drawing was correct at the time of going to print. Profiles, sizes and weights are given as indication only.



# InGranite Recon Ltd.

Reconstituted Stone | Modern Material | Classic Style

UK info@ingranite.co.uk

www.ingranite.co.uk

0808 2349118

RoI info@ingranite.ie

www.ingranite.ie

057 9331462

## Technical specification sheet

Title: Smooth window surround

Date: 07/04/2017

Ref: WD001

Scale: 1:12

Drawn by: InGranite

Approximate weight:

24kgs/meter



Lengths can be varied as required

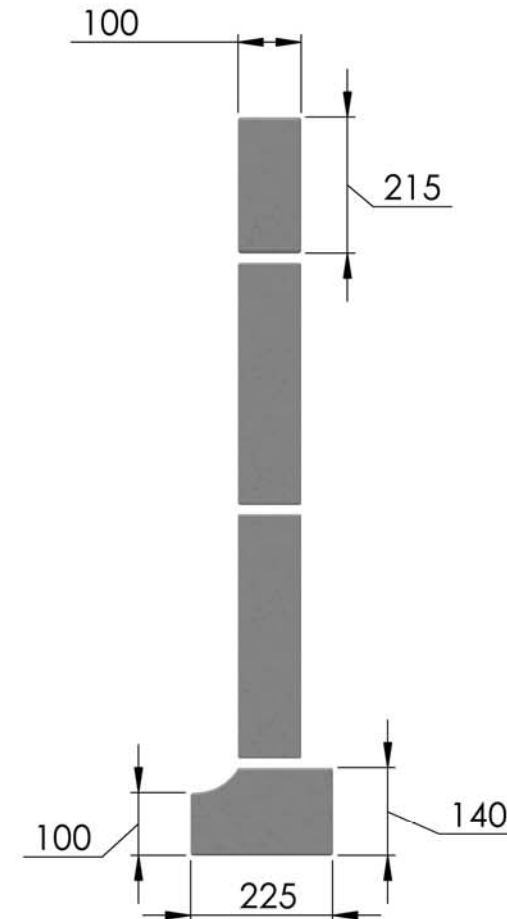
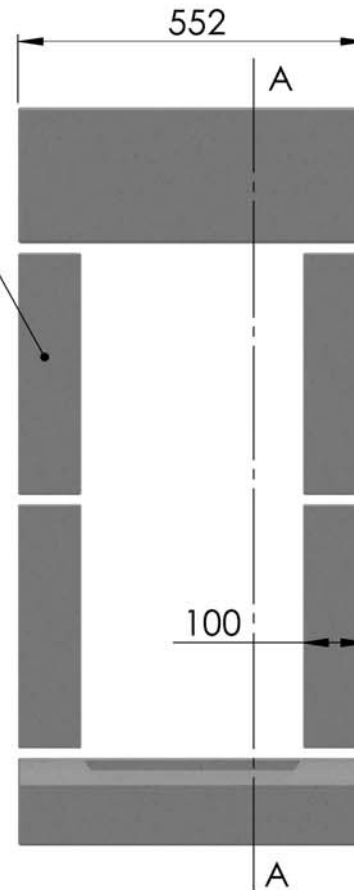

Section A-A

Head size
552
665
777
890
1002
1115
1227
1340
1452
1565
1677
1790
1902
2015
2127
2240
2352
2465
2578
2690

All dimensions are in millimetres. For non listed sizes please contact InGranite Recon LTD.

All vertical faces typically have a 4mm taper per 100mm of height.

The information contained in this drawing was correct at the time of going to print. Profiles, sizes and weights are given as indication only.