



InGranite Recon Ltd.

Cast Stone | Modern Material | Classic Style

Cast Stone Heads / Lintels

Contact

Phone:

Email:

Web:

UK

0808 2349 118

info@ingranite.co.uk

www.ingranite.co.uk

Rep. Irl.

057 9331 462

info@ingranite.ie

www.ingranite.ie





InGranite Recon Ltd.

Cast Stone | Modern Material | Classic Style

Cast Stone Heads / Lintels

InGranite Recon manufactures a range of cast stone heads/lintels units in beautiful and durable reconstituted granite. Please contact us if you require a bespoke or modified design for your project.

A Word on Terminology

The terms "head" and "lintel" are interchangeable as used here. Feel free to use the terms that you are used to when contacting us. We have been manufacturing for many years, so we'll know what you mean.

Contact

Phone:
Email:
Web:

UK

0808 2349 118
info@ingranite.co.uk
www.ingranite.co.uk

Rep Irl.

057 9331 462
info@ingranite.ie
www.ingranite.ie



InGranite Recon Ltd.

Reconstituted Stone | Modern Material | Classic Style

UK info@ingranite.co.uk

www.ingranite.co.uk

0808 2349118

RoI info@ingranite.ie

www.ingranite.ie

057 9331462

Technical specification sheet

Title: Keystone head

Date: 28/04/2017

Ref: H-001

Scale: 1:20

Drawn by: InGranite

Approximate weight: 51kgs/meter

Head size

665

777

890

1002

1115

1227

1340

1452

1565

1677

1790

1902

2015

2127

2240

2352

2465

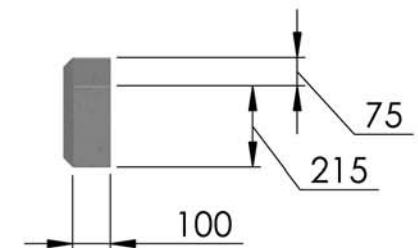
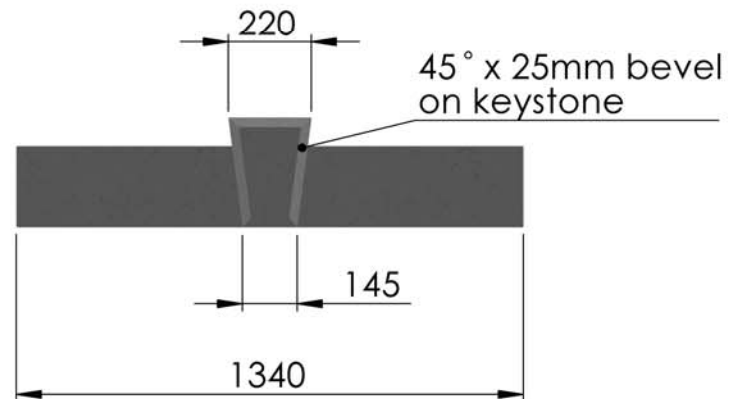

All dimensions are in millimetres. For non listed sizes please contact InGranite Recon LTD.

All vertical faces typically have a 4mm taper per 100mm of height.

The information contained in this drawing was correct at the time of going to print. Profiles, sizes and weights are given as indication only.



InGranite Recon Ltd.

Reconstituted Stone | Modern Material | Classic Style

UK info@ingranite.co.uk

www.ingranite.co.uk

0808 2349118

RoI info@ingranite.ie

www.ingranite.ie

057 9331462

Technical specification sheet

Title: Rockface head

Date: 28/04/2017

Ref: H-003

Scale: 1:15

Drawn by: InGranite

Approximate weight: 57kgs/meter

Head size

552

665

777

890

1002

1115

1227

1340

1452

1565

1677

1790

1902

2015

2127

2240

2352

2465

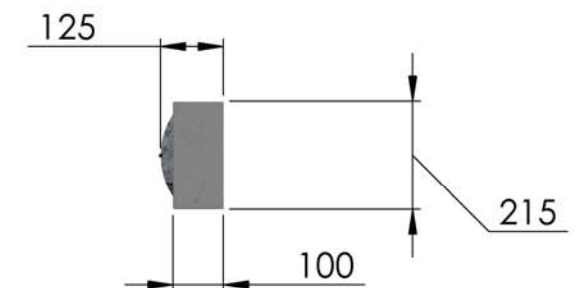
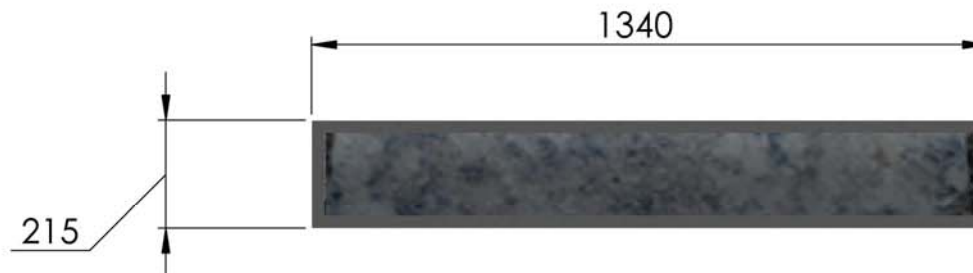

All dimensions are in millimetres. For non listed sizes please contact InGranite Recon LTD.

All vertical faces typically have a 4mm taper per 100mm of height.

The information contained in this drawing was correct at the time of going to print. Profiles, sizes and weights are given as indication only.



InGranite Recon Ltd.

Reconstituted Stone | Modern Material | Classic Style

UK info@ingranite.co.uk

www.ingranite.co.uk

0808 2349118

RoI info@ingranite.ie

www.ingranite.ie

057 9331462

Technical specification sheet

Title: 215 x 100 Smooth head

Date: 28/04/2017

Ref: H-002

Scale: 1:20

Drawn by: InGranite

Approximate weight: 51kgs/meter

| Head size |
|-----------|
| 665 |
| 777 |
| 890 |
| 1002 |
| 1115 |
| 1227 |
| 1340 |
| 1452 |
| 1565 |
| 1677 |
| 1790 |
| 1902 |
| 2015 |
| 2127 |
| 2240 |
| 2352 |
| 2465 |

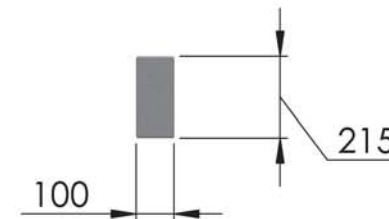

All dimensions are in millimetres. For non listed sizes please contact InGranite Recon LTD.

All vertical faces typically have a 4mm taper per 100mm of height.

The information contained in this drawing was correct at the time of going to print. Profiles, sizes and weights are given as indication only.



InGranite Recon Ltd.

Reconstituted Stone | Modern Material | Classic Style

UK info@ingranite.co.uk

www.ingranite.co.uk

0808 2349118

RoI info@ingranite.ie

www.ingranite.ie

057 9331462

Technical specification sheet

Title: 215 x 120 Smooth head

Date: 28/04/2017

Ref: H-002/120

Scale: 1:20

Drawn by: InGranite

Approximate weight:

62kgs/meter

| Head size |
|-----------|
| 665 |
| 777 |
| 890 |
| 1002 |
| 1115 |
| 1227 |
| 1340 |
| 1452 |
| 1565 |
| 1677 |
| 1790 |
| 1902 |
| 2015 |
| 2127 |
| 2240 |
| 2352 |
| 2465 |

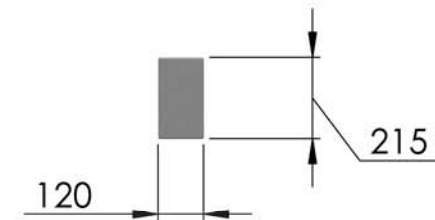
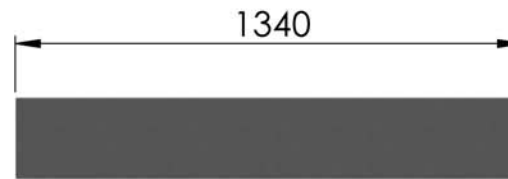

All dimensions are in millimetres. For non listed sizes please contact InGranite Recon LTD.

All vertical faces typically have a 4mm taper per 100mm of height.

The information contained in this drawing was correct at the time of going to print. Profiles, sizes and weights are given as indication only.